

Data Sheet

Itemnumber....: 3220631108

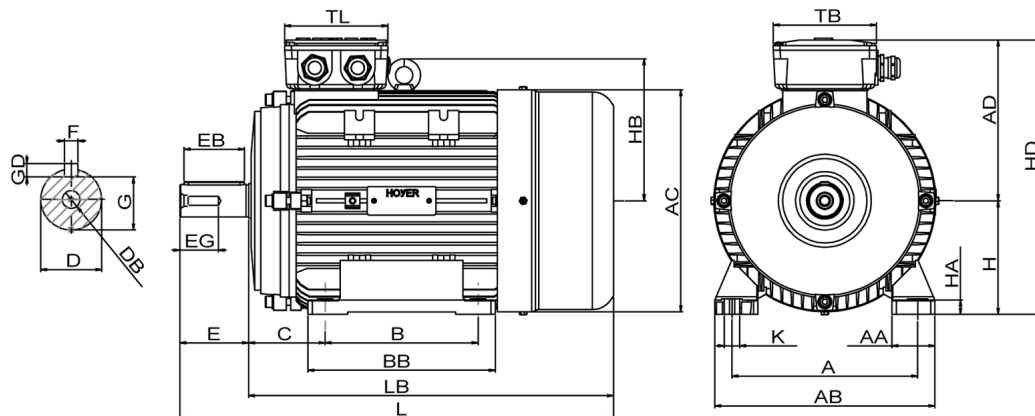

A = 100	AC = 120	BB = 108	DB = M4	EG = 10	GD = 4	HD = 166	LB = 195
AA = 22	AD = 103	C = 40	E = 23	F = 4	H = 63	K = 7	TB = 80
AB = 122	B = 80	D = 11	EB = 16	G = 8,50	HA = 9	L = 218	TL = 80

Version

Type.....: HMA2 63 2-2
Design.....: Induction motor
Standard series.....: IEC 60034
Phase / Voltage range.....: 3~ / Low

Electrical design

Efficiency.....: IE2
Pole.....: 2
Power at 50 Hz (kW).....: 0,25
Hz.....: 60 (60 Hz output)
Voltage.....: 440VY
Winding voltage.....: 230VD/400VY 50 Hz
Power output (kW).....: 0,29
Duty.....: S1
Insulation class.....: F
Temperature rise.....: B

Mechanical design

Frame size.....: 63
Mounting.....: B3
Rain cap.....: No
Protection class.....: IP55
Cooling method.....: IC411/TEFC
External grounding.....: Yes
Drain hole.....: Yes
Frame material.....: Aluminium
Material approval.....: None
Shaft.....: IEC standard
Key.....: Closed key
Balancing.....: Half key balancing
Vibration class.....: Grade-A
Weight (kg).....: 4,60

Environment condition

Ambient temp. min. (°C)....: -20
Ambient temp. max. (°C)....: 45
Altitude (mtr up to).....: 1000

Bearing

DE Bearing.....: 6201-ZZ/C3
NDE Bearing.....: 6201-ZZ/C3
Fixed bearing.....: DE

Terminal box

Tbox position.....: Top
Cable entry direction.....: Right (from DE)
Cable entry
Main.....: 1 x M20x1,5
Ø8-13mm metal
Accessory.....: 1 x M20x1,5
Metal blindcap
Terminal board thread.....: 6-M4

Test values

Rotor inertia (kgm²).....: 0,00025
Noise level (dB(A)).....: 60
No load current (A).....: 0,42
Winding resist. (ohm).....: 29,9
Starting time (sec.).....: 0,00
Temp. rise winding (K).....: 24
Temp. rise surface (K).....: 10

Motor protection

Thermal protection main....: PTC 3x 155 dgr
Thermal protection second..: None
Space heater.....: None
Temperature detector.....: No
SPM.....: No
IR wire.....: No
Tropical insulation.....: Yes

Explosion protection

According to.....: None
Type of protection.....: None

General

Direction of rotation.....: CW
Painting.....: RAL 9005
Nameplate.....: Multivoltage + VFD
Special packing.....: No
Special requirements.....: No

Rated power (kW)	0,25	0,24	0,30	0,29
Frequency (Hz)	50	50	60	60
Voltage (V)	230 400	220 380	280 480	440
Connection	D Y	D Y	D Y	Y
Full load current (A)	1,24 0,71	1,28 0,73	1,24 0,71	0,73
Speed (rpm)	2830	2830	3320	3320
Power factor cos(phi)	0,78	0,79	0,78	0,79
Efficiency, 100/75/50 (%)	64,8/ 65,8 /63,3	64,8/ 65,8 /63,3	64,8/ 65,8 /63,3	62,3/ 63,5 /60,7
Ist/In	5,60	4,95	5,60	5,15
Full load torque (Nm)	0,84	0,82	0,84	0,82
Tst/Tn	3,35	3,10	3,35	2,90
Tmax/Tn	3,40	3,15	3,40	2,95
Duty	S1	S1	S1	S1
Ambient temp. (°C)	40	45	40	45