

Data Sheet

Itemnumber....: 3220710108

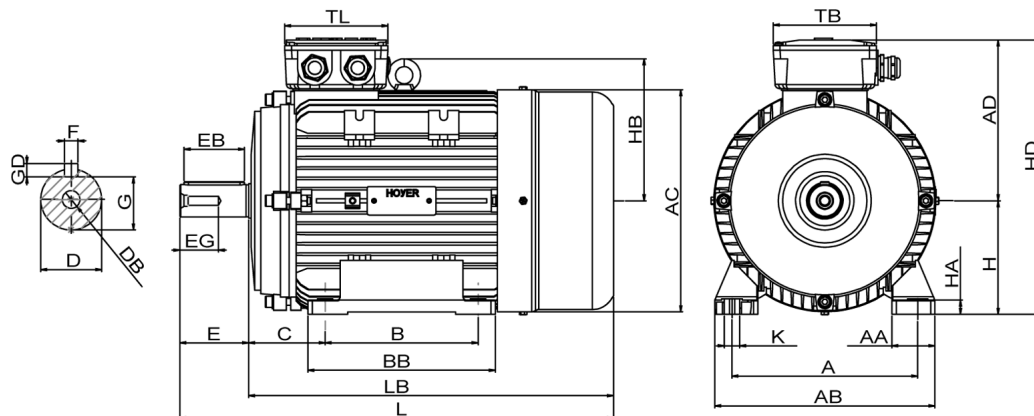

A = 112	AC = 139	BB = 113	DB = M5	EG = 13	GD = 5	HD = 184	LB = 219
AA = 24	AD = 113	C = 45	E = 30	F = 5	H = 71	K = 7	TB = 80
AB = 138	B = 90	D = 14	EB = 22	G = 11	HA = 9,50	L = 249	TL = 80

Version

Type.....: HMA2 71 1-2
Design.....: Induction motor
Standard series.....: IEC 60034
Phase / Voltage range.....: 3~ / Low

Electrical design

Efficiency.....: IE2
Pole.....: 2
Power at 50 Hz (kW).....: 0,37
Hz.....: 60 (60 Hz output)
Voltage.....: 440VY
Winding voltage.....: 230VD/400VY 50 Hz
Power output (kW).....: 0,43
Duty.....: S1
Insulation class.....: F
Temperature rise.....: B

Mechanical design

Frame size.....: 71
Mounting.....: B3
Rain cap.....: No
Protection class.....: IP55
Cooling method.....: IC411/TEFC
External grounding.....: Yes
Drain hole.....: Yes
Frame material.....: Aluminium
Material approval.....: None
Shaft.....: IEC standard
Key.....: Closed key
Balancing.....: Half key balancing
Vibration class.....: Grade-A
Weight (kg).....: 6,00

Environment condition

Ambient temp. min. (°C)....: -20
Ambient temp. max. (°C)....: 45
Altitude (mtr up to).....: 1000

Bearing

DE Bearing.....: 6202-ZZ/C3
NDE Bearing.....: 6202-ZZ/C3
Fixed bearing.....: DE

Terminal box

Tbox position.....: Top
Cable entry direction.....: Right (from DE)
Cable entry
Main.....: 1 x M20x1,5
Ø8-13mm metal
Accessory.....: 1 x M20x1,5
Metal blindcap
Terminal board thread.....: M4

Test values

Rotor inertia (kgm²).....: 0,00034
Noise level (dB(A)).....: 62
No load current (A).....: 0,45
Winding resist. (ohm).....: 22,9
Starting time (sec.).....: 0,00
Temp. rise winding (K).....: 31
Temp. rise surface (K).....: 13

Motor protection

Thermal protection main....: PTC 3x 155 dgr
Thermal protection second..: None
Space heater.....: None
Temperature detector.....: No
SPM.....: No
IR wire.....: No
Tropical insulation.....: Yes

Explosion protection

According to.....: None
Type of protection.....: None

General

Direction of rotation.....: CW
Painting.....: RAL 9005
Nameplate.....: Multivoltage + VFD
Special packing.....: No
Special requirements.....: No

Rated power (kW)	0,37	0,36	0,44	0,43
Frequency (Hz)	50	50	60	60
Voltage (V)	230 400	220 380	280 480	440
Connection	D Y	D Y	D Y	Y
Full load current (A)	1,56 0,90	1,60 0,93	1,56 0,90	0,93
Speed (rpm)	2750	2750	3320	3320
Power factor cos(phi)	0,86	0,86	0,86	0,88
Efficiency, 100/75/50 (%)	69,5/ 73,2 /72,5	69,5/ 73,2 /72,5	69,5/ 73,2 /72,5	67,4/ 71,3 /70,6
Ist/In	4,90	4,30	4,90	4,50
Full load torque (Nm)	1,28	1,24	1,28	1,24
Tst/Tn	2,75	2,60	2,75	2,40
Tmax/Tn	2,80	2,60	2,80	2,44
Duty	S1	S1	S1	S1
Ambient temp. (°C)	40	45	40	45