

# Data Sheet

Itemnumber....: 3220901109

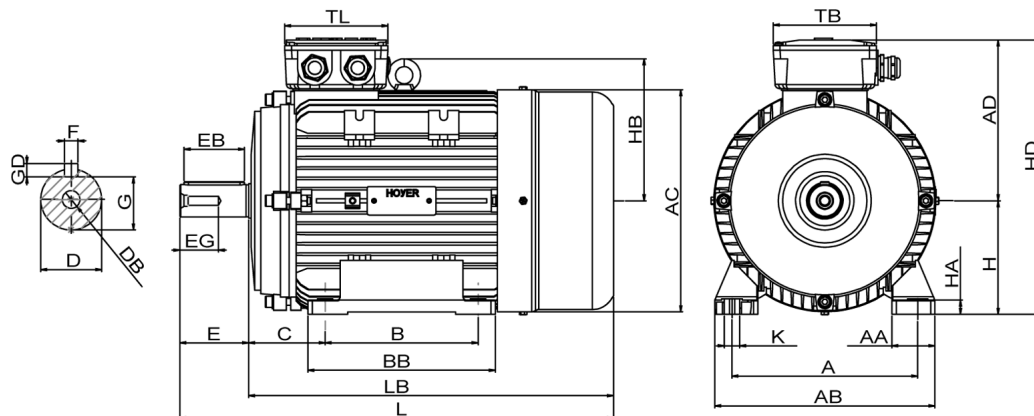

A = 140	AC = 175	BB = 155	DB = M8	EG = 24	GD = 7	HD = 222	LB = 312
AA = 35	AD = 132	C = 56	E = 50	F = 8	H = 90	K = 12	TB = 100
AB = 177	B = 125	D = 24	EB = 40	G = 20	HA = 13	L = 362	TL = 100

## Version

Type.....: HMA2 90L-2  
Design.....: Induction motor  
Standard series.....: IEC 60034  
Phase / Voltage range.....: 3~ / Low

## Electrical design

Efficiency.....: IE2  
Pole.....: 2  
Power at 50 Hz (kW).....: 2,20  
Hz.....: 60 (60 Hz output)  
Voltage.....: 440VY  
Winding voltage.....: 230VD/400VY 50 Hz  
Power output (kW).....: 2,55  
Duty.....: S1  
Insulation class.....: F  
Temperature rise.....: B

## Mechanical design

Frame size.....: 90  
Mounting.....: B3  
Rain cap.....: No  
Protection class.....: IP55  
Cooling method.....: IC411/TEFC  
External grounding.....: Yes  
Drain hole.....: Yes  
Frame material.....: Aluminium  
Material approval.....: None  
Shaft.....: IEC Standard  
Key.....: Closed key  
Balancing.....: Half key balancing  
Vibration class.....: Grade-A  
Weight (kg).....: 17,0

## Environment condition

Ambient temp. min. (°C)....: -20  
Ambient temp. max. (°C)....: 45  
Altitude (mtr up to).....: 1000

## Bearing

DE Bearing.....: 6205-ZZ/C3  
NDE Bearing.....: 6205-ZZ/C3  
Fixed bearing.....: DE

## Terminal box

Tbox position.....: Top  
Cable entry direction.....: Right (from DE)  
Cable entry  
Main.....: 1 x M20x1,5  
Ø8-13mm metal  
Accessory.....: 1 x M20x1,5  
Metal blindcap  
Terminal board thread.....: 6-M4

## Test values

Rotor inertia (kgm²).....: 0,0026  
Noise level (dB(A)).....: 66  
No load current (A).....: 2,00  
Winding resist. (ohm).....: 2,56  
Starting time (sec.).....: 0,00  
Temp. rise winding (K).....: 56  
Temp. rise surface (K).....: 47

## Motor protection

Thermal protection main....: PTC 3x 155 dgr  
Thermal protection second..: None  
Space heater.....: None  
Temperature detector.....: No  
SPM.....: No  
IR wire.....: No  
Tropical insulation.....: Yes

## Explosion protection

According to.....: None  
Type of protection.....: None

## General

Direction of rotation.....: CW  
Painting.....: RAL 9005  
Nameplate.....: Multivoltage + VFD  
Special packing.....: No  
Special requirements.....: No

Rated power (kW)	2,20	2,14	2,65	2,55
Frequency (Hz)	50	50	60	60
Voltage (V)	230 400	220 380	280 480	440
Connection	D Y	D Y	D Y	Y
Full load current (A)	7,70 4,45	7,95 4,55	7,70 4,45	4,55
Speed (rpm)	2870	2870	3450	3450
Power factor cos(phi)	0,86	0,87	0,86	0,86
Efficiency, 100/75/50 (%)	83,2/ 84,7 /84,5	83,2/ 84,7 /84,5	83,2/ 84,7 /84,5	82,0/ 83,6 /83,4
Ist/In	7,85	6,95	7,85	7,25
Full load torque (Nm)	7,30	7,10	7,30	7,10
Tst/Tn	3,20	2,95	3,20	2,75
Tmax/Tn	3,10	2,90	3,10	2,70
Duty	S1	S1	S1	S1
Ambient temp. (°C)	40	45	40	45