

Data Sheet

Itemnumber....: 3221320159

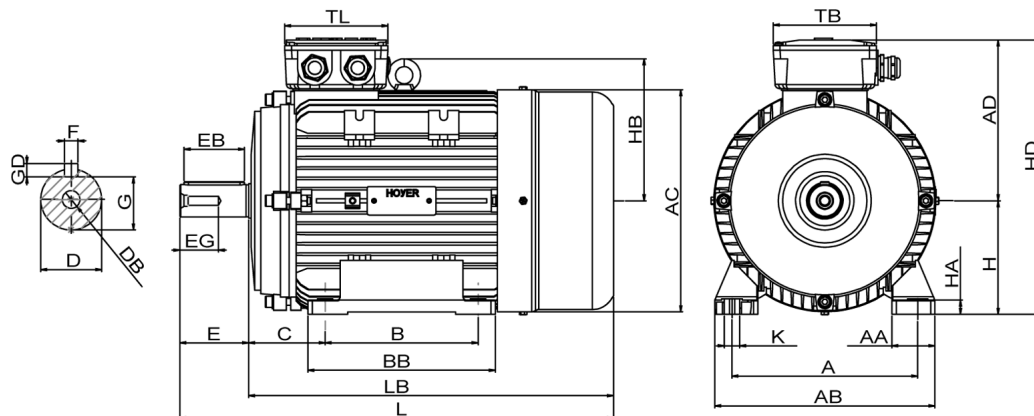

| | | | | | | | | |
|----------|----------|----------|----------|---------|------------|----------|----------|----------|
| A = 216 | AC = 258 | BB = 180 | DB = M12 | EG = 30 | GD = 8 | HB = 165 | L = 467 | TL = 120 |
| AA = 50 | AD = 187 | C = 89 | E = 80 | F = 10 | H = 132 | HD = 319 | LB = 387 | |
| AB = 256 | B = 140 | D = 38 | EB = 70 | G = 33 | HA = 16,50 | K = 12 | TB = 120 | |

Version

Type.....: HMA2 132S1-2
Design.....: Induction motor
Standard series.....: IEC 60034
Phase / Voltage range.....: 3~ / Low

Electrical design

Efficiency.....: IE2
Pole.....: 2
Power at 50 Hz (kW).....: 5,50
Hz.....: 60 (60 Hz output)
Voltage.....: 440VY
Winding voltage.....: 230VD/400VY 50 Hz
Power output (kW).....: 6,40
Duty.....: S1
Insulation class.....: F
Temperature rise.....: B

Mechanical design

Frame size.....: 132
Mounting.....: B3
Rain cap.....: No
Protection class.....: IP55
Cooling method.....: IC411/TEFC
External grounding.....: Yes
Drain hole.....: Yes
Frame material.....: Aluminium
Material approval.....: None
Shaft.....: IEC Standard
Key.....: Closed key
Balancing.....: Half key balancing
Vibration class.....: Grade-A
Weight (kg).....: 45,0

Environment condition

Ambient temp. min. (°C)....: -20
Ambient temp. max. (°C)....: 45
Altitude (mtr up to).....: 1000

Bearing

DE Bearing.....: 6308-ZZ/C3
NDE Bearing.....: 6308-ZZ/C3
Fixed bearing.....: DE

Terminal box

Tbox position.....: Top
Cable entry direction.....: Right (from DE)
Cable entry
Main.....: 2 x M25x1,5
Ø11-17mm metal
Accessory.....: 1 x M20x1,5
Metal blindcap
Terminal board thread.....: 6-M5

Test values

Rotor inertia (kgm²).....: 0,013
Noise level (dB(A)).....: 74
No load current (A).....: 3,00
Winding resist. (ohm).....: 0,72
Starting time (sec.).....: 0,00
Temp. rise winding (K).....: 52
Temp. rise surface (K).....: 32

Motor protection

Thermal protection main....: PTC 3x 155 dgr
Thermal protection second..: None
Space heater.....: None
Temperature detector.....: No
SPM.....: No
IR wire.....: No
Tropical insulation.....: Yes

Explosion protection

According to.....: None
Type of protection.....: None

General

Direction of rotation.....: CW
Painting.....: RAL 9005
Nameplate.....: Multivoltage + VFD
Special packing.....: No
Special requirements.....: No

| | | | | |
|---------------------------|------------------|------------------|------------------|------------------|
| Rated power (kW) | 5,50 | 5,35 | 6,60 | 6,40 |
| Frequency (Hz) | 50 | 50 | 60 | 60 |
| Voltage (V) | 230 400 | 220 380 | 280 480 | 440 |
| Connection | D Y | D Y | D Y | Y |
| Full load current (A) | 17,4 10,00 | 18,0 10,4 | 17,4 10,00 | 10,4 |
| Speed (rpm) | 2920 | 2920 | 3500 | 3500 |
| Power factor cos(phi) | 0,91 | 0,91 | 0,91 | 0,86 |
| Efficiency, 100/75/50 (%) | 87,0/ 87,3 /86,0 | 87,0/ 87,3 /86,0 | 87,0/ 87,3 /86,0 | 86,4/ 86,7 /85,3 |
| Ist/In | 7,70 | 6,75 | 7,70 | 7,05 |
| Full load torque (Nm) | 18,0 | 17,4 | 18,0 | 17,4 |
| Tst/Tn | 2,20 | 2,04 | 2,20 | 1,90 |
| Tmax/Tn | 2,90 | 2,70 | 2,90 | 2,50 |
| Duty | S1 | S1 | S1 | S1 |
| Ambient temp. (°C) | 40 | 45 | 40 | 45 |