

Data Sheet

Itemnumber....: 3223150199

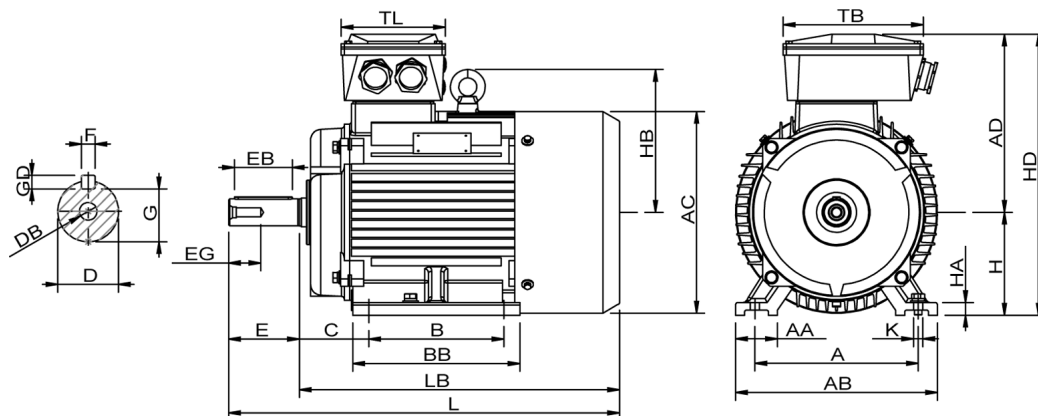

A = 508	AC = 620	BB = 570	DB = M20	EG = 56	GD = 11	HB = 432	L = 1178	TL = 280
AA = 120	AD = 546	C = 216	E = 140	F = 18	H = 315	HD = 861	LB = 1038	
AB = 628	B = 406	D = 65	EB = 110	G = 58	HA = 45	K = 28	TB = 400	

Version

Type.....: HMC2 315S-2
Design.....: Induction motor
Standard series.....: IEC 60034
Phase / Voltage range.....: 3~ / Low

Electrical design

```

Efficiency.....: IE2
Pole.....: 2
Power at 50 Hz (kW).....: 110
Hz.....: 60 (60 Hz output)
Voltage.....: 690VD
Winding voltage.....: 690VD 60 Hz
Power output (kW).....: 128
Duty.....: S1
Insulation class.....: F
Temperature rise.....: B

```

Mechanical design

```

Mechanical Design.....: 315
Mounting.....: B3
Rain cap.....: No
Protection class.....: IP55
Cooling method.....: IC411/TEFC
External grounding.....: Yes
Drain hole.....: Yes
Frame material.....: Cast Iron
Material approval.....: None
Shaft.....: IEC Standard
Key.....: Closed key
Balancing.....: Half key balancing
Vibration class.....: Grade-A
Weight (kg).....: 880

```

Environment condition

```
Ambient temp. min. (°C)..: -20
Ambient temp. max. (°C)..: 45
Altitude (mtr up to).....: 1000
```

Motor protection

```

Thermal protection main....: PTC 3x 155 dgr
Thermal protection second..: None
Space heater.....: 1x 230V 100W
Temperature detector.....: No
SPM.....: No
IR wire.....: Yes
Tropical insulation.....: Yes

```

Explosion protection

```

According to.....: None
Type of protection.....: None

```

General

```

Direction of rotation.....: CW
Painting.....: RAL 9005
Nameplate.....: Multivoltage + VFD
Special packing.....: No
Special requirements.....: No

```

Bearing

Bearing
DE Bearing.....: 6317/C3
NDE Bearing.....: 6317/C3
Fixed bearing.....: DE

Terminal box

```

Thox position.....: Top
Cable entry direction.....: Right (from DE)
Cable entry
    Main.....: 2 x M63x1,5
                  Ø37-44mm metal
    Accessory.....: 2 x M20x1,5
                  Metal blindcaps
Terminal board thread.....: 6-M16

```

Test values

```

Rotor inertia (kgm2).....: 1,47
Noise level (dB(A)).....: 85
No load current (A).....: 24,2
Winding resist. (ohm).....: 0,038
Starting time (sec.).....: 0,79
Temp. rise winding (K).....: 62
Temp. rise surface (K).....: 35

```

Rated power (kW)	110	132	128
Frequency (Hz)	50	60	60
Voltage (V)	575	690	690
Connection	D	D	D
Full load current (A)	128	130	126
Speed (rpm)	2980	3560	3560
Power factor cos(phi)	0,92	0,92	0,92
Efficiency, 100/75/50 (%) . .	94,3/ 93,4 /92,3	94,3/ 93,4 /92,3	94,3/ 93,4 /92,3
Ist/In	7,85	7,85	8,05
Full load torque (Nm)	350	350	340
Tst/Tn	2,14	2,14	2,20
Tmax/Tn	2,14	2,14	2,20
Duty	S1	S1	S1
Ambient temp. (°C)	40	40	45