

# Data Sheet

Itemnumber....: 3240801109

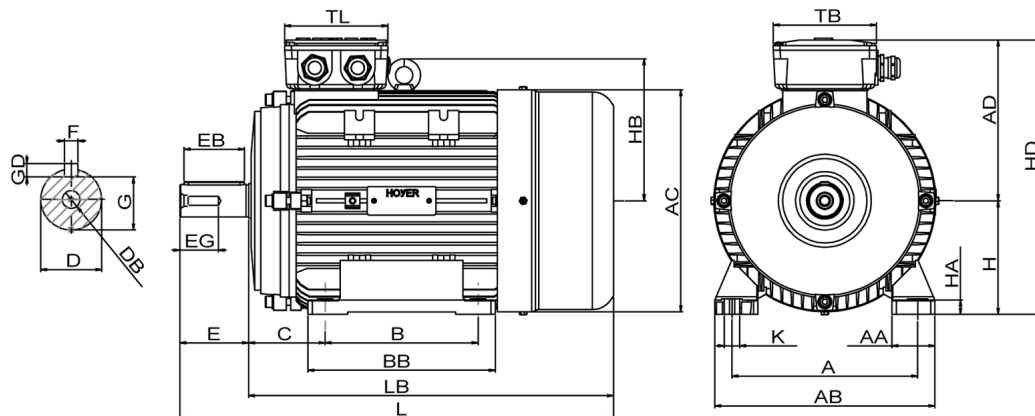

A = 125	AC = 159	BB = 122	DB = M6	EG = 16	GD = 6	HD = 206	LB = 254
AA = 27	AD = 126	C = 50	E = 40	F = 6	H = 80	K = 10	TB = 100
AB = 159	B = 100	D = 19	EB = 32	G = 15,50	HA = 12	L = 294	TL = 100

## Version

Type.....: HMA2 80 2-4  
Design.....: Induction motor  
Standard series.....: IEC 60034  
Phase / Voltage range.....: 3~ / Low

## Electrical design

Efficiency.....: IE2  
Pole.....: 4  
Power at 50 Hz (kW).....: 0,75  
Hz.....: 60 (60 Hz output)  
Voltage.....: 440VY  
Winding voltage.....: 230VD/400VY 50 Hz  
Power output (kW).....: 0,87  
Duty.....: S1  
Insulation class.....: F  
Temperature rise.....: B

## Mechanical design

Frame size.....: 80  
Mounting.....: B3  
Rain cap.....: No  
Protection class.....: IP55  
Cooling method.....: IC411/TEFC  
External grounding.....: Yes  
Drain hole.....: Yes  
Frame material.....: Aluminium  
Material approval.....: None  
Shaft.....: IEC Standard  
Key.....: Closed key  
Balancing.....: Half key balancing  
Vibration class.....: Grade-A  
Weight (kg).....: 13,0

## Environment condition

Ambient temp. min. (°C)....: -20  
Ambient temp. max. (°C)....: 45  
Altitude (mtr up to).....: 1000

## Bearing

DE Bearing.....: 6204-ZZ/C3  
NDE Bearing.....: 6204-ZZ/C3  
Fixed bearing.....: DE

## Terminal box

Tbox position.....: Top  
Cable entry direction.....: Right (from DE)  
Cable entry  
Main.....: 1 x M20x1,5  
Ø8-13mm metal  
Accessory.....: 1 x M20x1,5  
Metal blindcap  
Terminal board thread.....: 6-M4

## Test values

Rotor inertia (kgm²).....: 0,0025  
Noise level (dB(A)).....: 56  
No load current (A).....: 1,16  
Winding resist. (ohm).....: 6,69  
Starting time (sec.).....: 0,00  
Temp. rise winding (K).....: 54  
Temp. rise surface (K).....: 52

## Motor protection

Thermal protection main....: PTC 3x 155 dgr  
Thermal protection second..: None  
Space heater.....: None  
Temperature detector.....: No  
SPM.....: No  
IR wire.....: No  
Tropical insulation.....: Yes

## Explosion protection

According to.....: None  
Type of protection.....: None

## General

Direction of rotation.....: CW  
Painting.....: RAL 9005  
Nameplate.....: Multivoltage + VFD  
Special packing.....: No  
Special requirements.....: No

Rated power (kW)	0,75	0,73	0,90	0,87
Frequency (Hz)	50	50	60	60
Voltage (V)	230 400	220 380	280 480	440
Connection	D Y	D Y	D Y	Y
Full load current (A)	3,25 1,86	3,30 1,92	3,25 1,86	1,92
Speed (rpm)	1430	1430	1720	1720
Power factor cos(phi)	0,73	0,75	0,73	0,81
Efficiency, 100/75/50 (%)	79,6/ 80,7 /79,3	79,6/ 80,7 /79,3	79,6/ 80,7 /79,3	78,2/ 79,4 /77,8
Ist/In	6,10	5,40	6,10	5,60
Full load torque (Nm)	5,00	4,85	5,00	4,85
Tst/Tn	2,95	2,75	2,95	2,55
Tmax/Tn	2,90	2,70	2,90	2,50
Duty	S1	S1	S1	S1
Ambient temp. (°C)	40	45	40	45