

Data Sheet

Itemnumber....: 3241001109

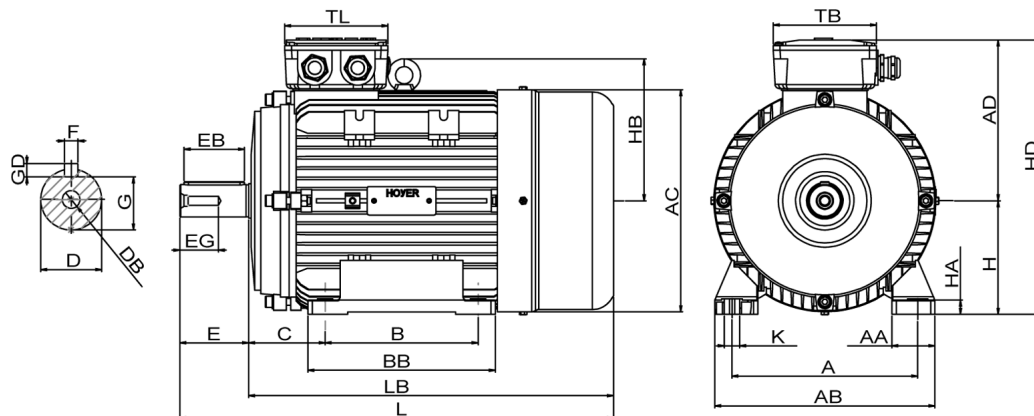

A = 160	AC = 198	BB = 176	DB = M10	EG = 28	GD = 7	HB = 135	L = 401	TL = 100
AA = 42	AD = 147	C = 63	E = 60	F = 8	H = 100	HD = 247	LB = 341	
AB = 205	B = 140	D = 28	EB = 50	G = 24	HA = 12	K = 12	TB = 100	

Version

Type.....: HMA2 100L2-4
Design.....: Induction motor
Standard series.....: IEC 60034
Phase / Voltage range.....: 3~ / Low

Electrical design

Efficiency.....: IE2
Pole.....: 4
Power at 50 Hz (kW).....: 3,00
Hz.....: 60 (60 Hz output)
Voltage.....: 440VY
Winding voltage.....: 230VD/400VY 50 Hz
Power output (kW).....: 3,50
Duty.....: S1
Insulation class.....: F
Temperature rise.....: B

Mechanical design

Frame size.....: 100
Mounting.....: B3
Rain cap.....: No
Protection class.....: IP55
Cooling method.....: IC411/TEFC
External grounding.....: Yes
Drain hole.....: Yes
Frame material.....: Aluminium
Material approval.....: None
Shaft.....: IEC Standard
Key.....: Closed key
Balancing.....: Half key balancing
Vibration class.....: Grade-A
Weight (kg).....: 28,0

Environment condition

Ambient temp. min. (°C)....: -20
Ambient temp. max. (°C)....: 45
Altitude (mtr up to).....: 1000

Bearing

DE Bearing.....: 6206-ZZ/C3
NDE Bearing.....: 6206-ZZ/C3
Fixed bearing.....: DE

Terminal box

Tbox position.....: Top
Cable entry direction.....: Right (from DE)
Cable entry
Main.....: 1 x M20x1,5
Ø8-13mm metal
Accessory.....: 1 x M20x1,5
Metal blindcap
Terminal board thread.....: 6-M4

Test values

Rotor inertia (kgm²).....: 0,0087
Noise level (dB(A)).....: 63
No load current (A).....: 3,50
Winding resist. (ohm).....: 1,24
Starting time (sec.).....: 10,00
Temp. rise winding (K).....: 66
Temp. rise surface (K).....: 47

Motor protection

Thermal protection main....: PTC 3x 155 dgr
Thermal protection second..: None
Space heater.....: None
Temperature detector.....: No
SPM.....: No
IR wire.....: No
Tropical insulation.....: Yes

Explosion protection

According to.....: None
Type of protection.....: None

General

Direction of rotation.....: CW
Painting.....: RAL 9005
Nameplate.....: Multivoltage + VFD
Special packing.....: No
Special requirements.....: No

Rated power (kW)	3,00	2,90	3,60	3,50
Frequency (Hz)	50	50	60	60
Voltage (V)	230 400	220 380	280 480	440
Connection	D Y	D Y	D Y	Y
Full load current (A)	11,2 6,50	11,6 6,70	11,2 6,50	6,70
Speed (rpm)	1450	1450	1740	1740
Power factor cos(phi)	0,79	0,80	0,79	0,83
Efficiency, 100/75/50 (%)	85,6/ 85,5 /84,0	85,6/ 85,5 /84,0	85,6/ 85,5 /84,0	84,6/ 84,5 /82,9
Ist/In	7,30	6,40	7,30	6,70
Full load torque (Nm)	20,0	19,4	20,0	19,4
Tst/Tn	2,60	2,42	2,60	2,26
Tmax/Tn	3,40	3,15	3,40	2,95
Duty	S1	S1	S1	S1
Ambient temp. (°C)	40	45	40	45