

Data Sheet

Itemnumber..... 3242802199

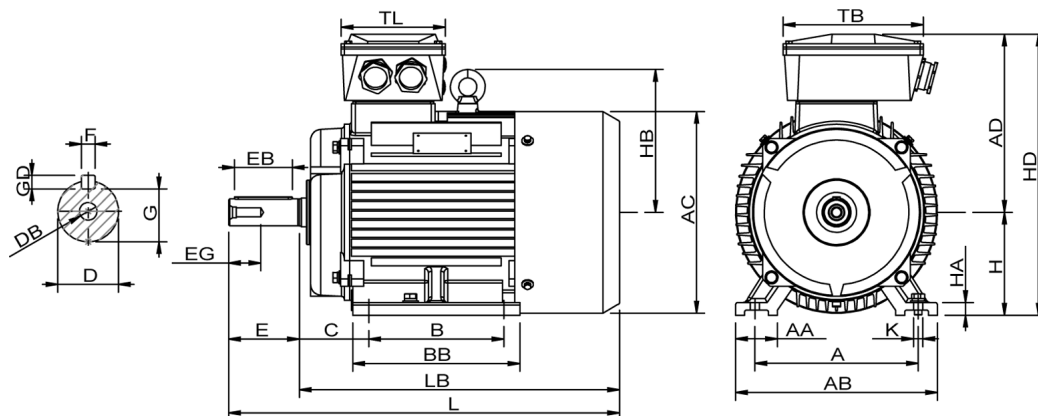

A = 457	AC = 558	BB = 536	DB = M20	EG = 56	GD = 12	HB = 407	L = 1097	TL = 230
AA = 85	AD = 419	C = 190	E = 140	F = 20	H = 280	HD = 699	LB = 957	
AB = 542	B = 419	D = 75	EB = 110	G = 67,50	HA = 35	K = 24	TB = 305	

Version

Type..... HMC2 280MB-4
Design..... Induction motor
Standard series..... IEC 60034
Phase / Voltage range..... 3~ / Low

Electrical design

Efficiency..... IE2
Pole..... 4
Power at 50 Hz (kW)..... 110
Hz..... 60 (60 Hz output)
Voltage..... 690VD
Winding voltage..... 690VD 60 Hz
Power output (kW)..... 128
Duty..... S1
Insulation class..... F
Temperature rise..... B

Mechanical design

Frame size..... 280MB
Mounting..... B3
Rain cap..... No
Protection class..... IP55
Cooling method..... IC411/TEFC
External grounding..... Yes
Drain hole..... Yes
Frame material..... Cast Iron
Material approval..... None
Shaft..... IEC Standard
Key..... Closed key
Balancing..... Half key balancing
Vibration class..... Grade-A
Weight (kg)..... 811

Environment condition

Ambient temp. min. (°C)..... -20
Ambient temp. max. (°C)..... 45
Altitude (mtr up to)..... 1000

Bearing

DE Bearing..... 6317/C3
NDE Bearing..... 6317/C3
Fixed bearing..... DE

Terminal box

Tbox position..... Top
Cable entry direction..... Right (from DE)
Cable entry
Main..... 2 x M63x1,5
Ø37-44mm metal
Accessory..... 2 x M20x1,5
Metal blindcaps
Terminal board thread..... 6-M10

Test values

Rotor inertia (kgm²)..... 2,53
No load current (A)..... 39,5
Winding resist. (ohm)..... 0,069
Starting time (sec.)..... 0,22

Motor protection

Thermal protection main..... PTC 3x 155 dgr
Thermal protection second.. None
Space heater..... 1x 230V 100W
Temperature detector..... No
SPM..... No
IR wire..... Yes
Tropical insulation..... Yes

Explosion protection

According to..... None
Type of protection..... None

General

Direction of rotation..... CW
Painting..... RAL 9005
Nameplate..... Multivoltage + VFD
Special packing..... No
Special requirements..... No

Rated power (kW)	110	132	128
Frequency (Hz)	50	60	60
Voltage (V)	575	690	690
Connection	D	D	D
Full load current (A)	132	132	128
Speed (rpm)	1490	1780	1780
Power factor cos(phi)	0,88	0,88	0,88
Efficiency, 100/75/50 (%)	94,5/ 93,7 /92,3	94,5/ 93,7 /92,3	94,5/ 93,7 /92,3
Ist/In	7,55	7,55	7,75
Full load torque (Nm)	705	705	685
Tst/Tn	2,65	2,65	2,75
Tmax/Tn	3,40	3,40	3,50
Duty	S1	S1	S1
Ambient temp. (°C)	40	40	45