

Data Sheet

Itemnumber....: 3243552109

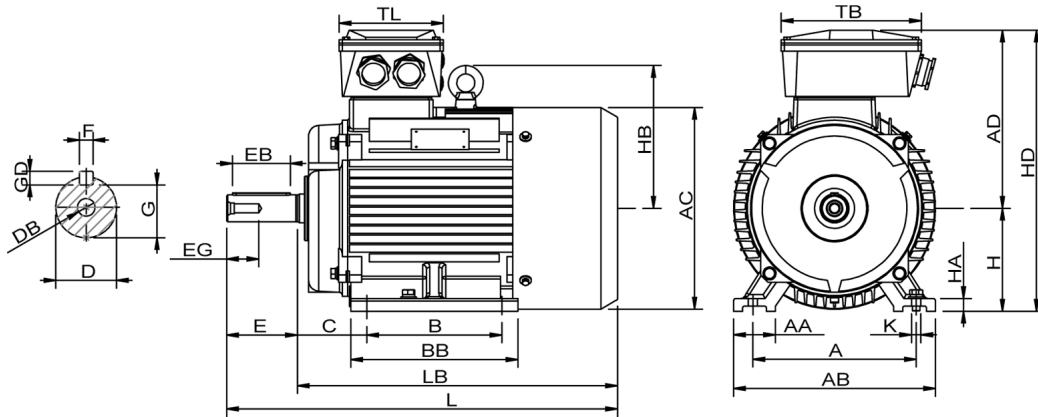

A = 610	AC = 698	BE = 750	DB = M24	EG = 56	GD = 14	HB = 492	L = 1619	TL = 330
AA = 116	AD = 661	C = 254	E = 170	F = 25	H = 355	HD = 1016	LB = 1349	
AB = 726	B = 630	D = 95	EB = 160	G = 86	HA = 52	K = 28	TB = 460	

Version

Type.....: HMC2 355L1-4
Design.....: Induction motor
Standard series.....: IEC 60034
Phase / Voltage range.....: 3~ / Low

Electrical design

Efficiency.....	IE2
Pole.....	4
Power at 50 Hz (kW).....	355
Hz.....	60 (60 Hz output)
Voltage.....	440VD
Winding voltage.....	400VD/690VY 50 Hz
Power output (kW).....	415
Duty.....	S1
Insulation class.....	F
Temperature rise.....	F

Mechanical design

Frame size.....	355
Mounting.....	B3
Rain cap.....	No
Protection class.....	IP55
Cooling method.....	IC411/TEFC
External grounding.....	Yes
Drain hole.....	Yes
Frame material.....	Cast Iron
Material approval.....	None
Shaft.....	IEC Standard
Key.....	Closed key
Balancing.....	Half key balancing
Vibration class.....	Grade-A
Weight (kg).....	2.120

Environment condition

```
Ambient temp. min. (°C)..: -20
Ambient temp. max. (°C)..: 45
Altitude (mtr up to).....: 1000
```

Bearing

DE Bearing.....: 6322/C3
NDE Bearing.....: 6322/C3
Fixed bearing.....: DE

Terminal box

```
Tbox position.....: Top
Cable entry direction.....: Right (from DE)
Cable entry
  Main.....: 2 x M72x2,0
               Ø46-52mm metal
  Accessory.....: 2 x M20x1,5
                  Metal blindcaps
Terminal board thread.....: 6-M16
```

Test values

```

Rotor inertia (kgm2).....: 12,2
No load current (A).....: 152
Winding resist. (ohm).....: 0,0063
Starting time (sec.).....: 0,41

```

Motor protection

```

Thermal protection main....: PTC 3x 155 dgr
Thermal protection second..: None
Space heater.....: 1x 230V 100W
Temperature detector.....: No
SPM.....: No
IR wire.....: No
Tropical insulation.....: Yes

```

Explosion protection

```
According to.....: None
Type of protection.....: None
```

General

```
Direction of rotation.....: CW
Painting.....: RAL 9005
Nameplate.....: Multivoltage + VFD
Special packing.....: No
Special requirements.....: No
```

Rated power (kW)	355		345		425		415
Frequency (Hz)	50		50		60		60
Voltage (V)	400	690	380	660	480	830	440
Connection	D	Y	D	Y	D	Y	D
Full load current (A) . . .	595	345	610	355	595	345	625
Speed (rpm)	1490		1490		1780		1780
Power factor cos(phi) . . .	0,91		0,91		0,91		0,92
Efficiency, 100/75/50 (%) :	95,1/ 95,1 /94,7		95,1/ 95,1 /94,7		95,1/ 95,1 /94,7		94,8/ 94,7 /94,4
Ist/In	6,50		5,70		6,50		5,95
Full load torque (Nm) . . .	2.280		2.200		2.280		2.200
Tst/Tn	2,32		2,16		2,32		2,00
Tmax/Tn	2,75		2,55		2,75		2,38
Duty	S1		S1		S1		S1
Ambient temp. (°C)	40		45		40		45