

# Data Sheet

Itemnumber....: 3260710108

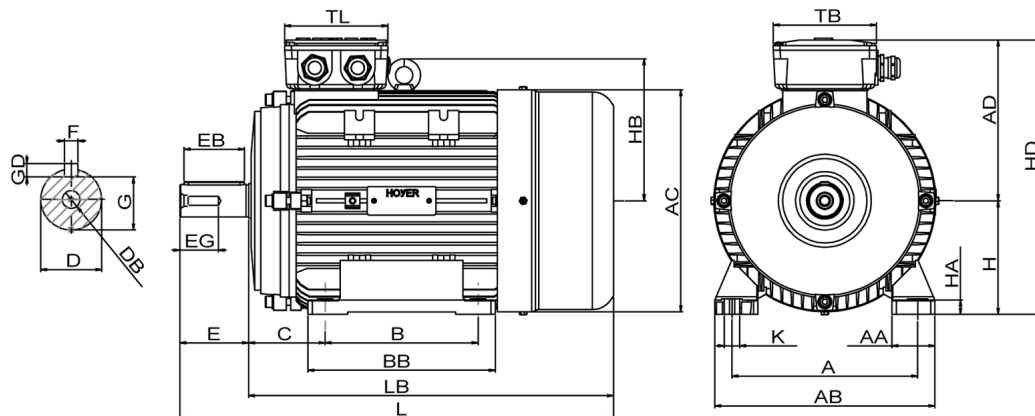

A = 112	AC = 139	BB = 113	DB = M5	EG = 13	GD = 5	HD = 184	LB = 219
AA = 24	AD = 113	C = 45	E = 30	F = 5	H = 71	K = 7	TB = 80
AB = 138	B = 90	D = 14	EB = 22	G = 11	HA = 9,50	L = 249	TL = 80

## Version

Type.....: HMA2 71 1-6  
Design.....: Induction motor  
Standard series.....: IEC 60034  
Phase / Voltage range.....: 3~ / Low

## Electrical design

Efficiency.....: IE2  
Pole.....: 6  
Power at 50 Hz (kW).....: 0,18  
Hz.....: 60 (60 Hz output)  
Voltage.....: 440VY  
Winding voltage.....: 230VD/400VY 50 Hz  
Power output (kW).....: 0,21  
Duty.....: S1  
Insulation class.....: F  
Temperature rise.....: B

## Mechanical design

Frame size.....: 71  
Mounting.....: B3  
Rain cap.....: No  
Protection class.....: IP55  
Cooling method.....: IC411/TEFC  
External grounding.....: Yes  
Drain hole.....: Yes  
Frame material.....: Aluminium  
Material approval.....: None  
Shaft.....: IEC standard  
Key.....: Closed key  
Balancing.....: Half key balancing  
Vibration class.....: Grade-A  
Weight (kg).....: 6,00

## Environment condition

Ambient temp. min. (°C)....: -20  
Ambient temp. max. (°C)....: 45  
Altitude (mtr up to).....: 1000

## Bearing

DE Bearing.....: 6202-ZZ/C3  
NDE Bearing.....: 6202-ZZ/C3  
Fixed bearing.....: DE

## Terminal box

Tbox position.....: Top  
Cable entry direction.....: Right (from DE)  
Cable entry  
Main.....: 1 x M20x1,5  
Ø8-13mm metal  
Accessory.....: 1 x M20x1,5  
Metal blindcap  
Terminal board thread.....: M4

## Test values

Rotor inertia (kgm²).....: 0,0013  
Noise level (dB(A)).....: 54  
No load current (A).....: 0,60  
Winding resist. (ohm).....: 42,5  
Temp. rise winding (K).....: 33  
Temp. rise surface (K).....: 43

## Motor protection

Thermal protection main....: PTC 3x 155 dgr  
Thermal protection second..: None  
Space heater.....: None  
Temperature detector.....: No  
SPM.....: No  
IR wire.....: No  
Tropical insulation.....: Yes

## Explosion protection

According to.....: None  
Type of protection.....: None

## General

Direction of rotation.....: CW  
Painting.....: RAL 9005  
Nameplate.....: Multivoltage + VFD  
Special packing.....: No  
Special requirements.....: No

Rated power (kW) . . . . .	0,18	0,17	0,22	0,21
Frequency (Hz) . . . . .	50	50	60	60
Voltage (V) . . . . .	230 400	220 380	280 480	440
Connection . . . . .	D Y	D Y	D Y	Y
Full load current (A) . . . .	1,34 0,77	1,38 0,79	1,34 0,77	0,79
Speed (rpm) . . . . .	930	930	1070	1070
Power factor cos(phi) . . . .	0,60	0,62	0,60	0,66
Efficiency, 100/75/50 (%) . .	56,6/ 56,1 /50,8	56,6/ 56,1 /50,8	56,6/ 56,1 /50,8	53,6/ 53,1 /47,3
Ist/In . . . . .	3,25	2,85	3,25	3,00
Full load torque (Nm) . . . .	1,86	1,80	1,86	1,80
Tst/Tn . . . . .	2,40	2,22	2,40	2,06
Tmax/Tn . . . . .	2,30	2,14	2,30	2,00
Duty . . . . .	S1	S1	S1	S1
Ambient temp. (°C) . . . . .	40	45	40	45