

Data Sheet

Itemnumber....: 3261120159

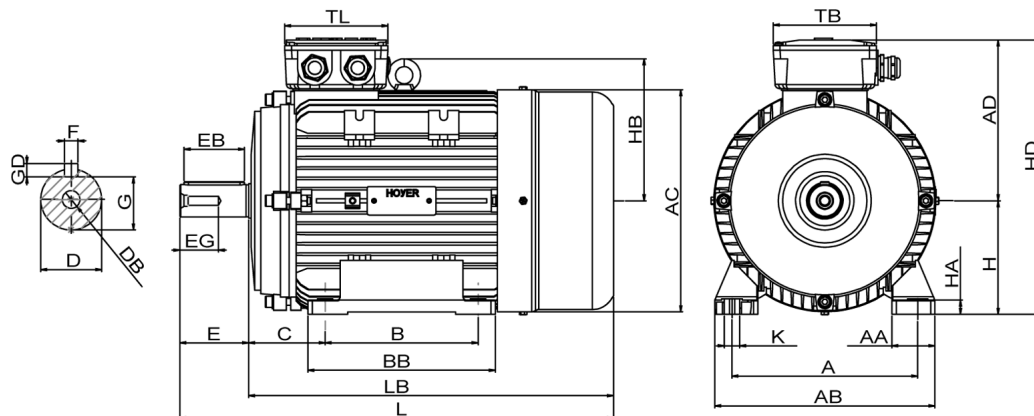

A = 190	AC = 219	BB = 180	DB = M10	EG = 28	GD = 7	HB = 145	L = 405	TL = 120
AA = 45	AD = 168	C = 70	E = 60	F = 8	H = 112	HD = 280	LB = 345	
AB = 222	B = 140	D = 28	EB = 50	G = 24	HA = 13	K = 12	TB = 120	

Version

Type.....: HMA2 112M1-6
Design.....: Induction motor
Standard series.....: IEC 60034
Phase / Voltage range.....: 3~ / Low

Electrical design

Efficiency.....: IE2
Pole.....: 6
Power at 50 Hz (kW).....: 2,20
Hz.....: 60 (60 Hz output)
Voltage.....: 440VD
Winding voltage.....: 400VD/690VY 50 Hz
Power output (kW).....: 2,55
Duty.....: S1
Insulation class.....: F
Temperature rise.....: B

Mechanical design

Frame size.....: 112
Mounting.....: B3
Rain cap.....: No
Protection class.....: IP55
Cooling method.....: IC411/TEFC
External grounding.....: Yes
Drain hole.....: Yes
Frame material.....: Aluminium
Material approval.....: None
Shaft.....: IEC Standard
Key.....: Closed key
Balancing.....: Half key balancing
Vibration class.....: Grade-A
Weight (kg).....: 35,0

Environment condition

Ambient temp. min. (°C)....: -20
Ambient temp. max. (°C)....: 45
Altitude (mtr up to).....: 1000

Bearing

DE Bearing.....: 6306-ZZ/C3
NDE Bearing.....: 6306-ZZ/C3
Fixed bearing.....: DE

Terminal box

Tbox position.....: Top
Cable entry direction.....: Right (from DE)
Cable entry
Main.....: 1 x M20x1,5
Ø8-13mm metal
Accessory.....: 1 x M20x1,5
Metal blindcap
Terminal board thread.....: 6-M5

Test values

Rotor inertia (kgm²).....: 0,014
Noise level (dB(A)).....: 62
No load current (A).....: 3,35
Winding resist. (ohm).....: 6,15
Starting time (sec.).....: 0,00
Temp. rise winding (K).....: 71
Temp. rise surface (K).....: 64

Motor protection

Thermal protection main....: PTC 3x 155 dgr
Thermal protection second..: None
Space heater.....: None
Temperature detector.....: No
SPM.....: No
IR wire.....: No
Tropical insulation.....: Yes

Explosion protection

According to.....: None
Type of protection.....: None

General

Direction of rotation.....: CW
Painting.....: RAL 9005
Nameplate.....: Multivoltage + VFD
Special packing.....: No
Special requirements.....: No

Rated power (kW)	2,20	2,14	2,65	2,55
Frequency (Hz)	50	50	60	60
Voltage (V)	400 690	380 660	480 830	440
Connection	D Y	D Y	D Y	D
Full load current (A)	5,20 3,05	5,40 3,10	5,20 3,05	5,40
Speed (rpm)	960	960	1150	1150
Power factor cos(phi)	0,74	0,76	0,74	0,74
Efficiency, 100/75/50 (%)	81,8/ 81,2 /78,1	81,8/ 81,2 /78,1	81,8/ 81,2 /78,1	80,5/ 79,9 /76,5
Ist/In	7,10	6,25	7,10	6,55
Full load torque (Nm)	21,8	21,2	21,8	21,2
Tst/Tn	2,75	2,55	2,75	2,38
Tmax/Tn	2,80	2,60	2,80	2,42
Duty	S1	S1	S1	S1
Ambient temp. (°C)	40	45	40	45