

# Data Sheet

Itemnumber..... 3262800109

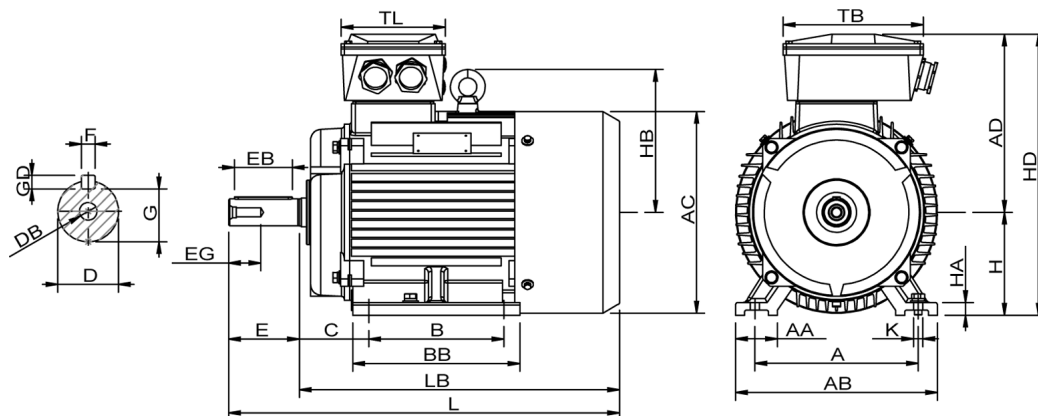

|          |          |          |          |           |         |          |          |          |
|----------|----------|----------|----------|-----------|---------|----------|----------|----------|
| A = 457  | AC = 546 | BB = 485 | DB = M20 | EG = 56   | GD = 12 | HB = 362 | L = 985  | TL = 230 |
| AA = 85  | AD = 403 | C = 190  | E = 140  | F = 20    | H = 280 | HD = 683 | LB = 845 |          |
| AB = 542 | B = 368  | D = 75   | EB = 110 | G = 67,50 | HA = 35 | K = 24   | TB = 305 |          |

## Version

Type..... HMC2 280S-6  
Design..... Induction motor  
Standard series..... IEC 60034  
Phase / Voltage range..... 3~ / Low

## Electrical design

Efficiency..... IE2  
Pole..... 6  
Power at 50 Hz (kW)..... 45,0  
Hz..... 60 (60 Hz output)  
Voltage..... 440VD  
Winding voltage..... 400VD/690VY 50 Hz  
Power output (kW)..... 52,5  
Duty..... S1  
Insulation class..... F  
Temperature rise..... B

## Mechanical design

Frame size..... 280  
Mounting..... B3  
Rain cap..... No  
Protection class..... IP55  
Cooling method..... IC411/TEFC  
External grounding..... Yes  
Drain hole..... Yes  
Frame material..... Cast Iron  
Material approval..... None  
Shaft..... IEC Standard  
Key..... Closed key  
Balancing..... Half key balancing  
Vibration class..... Grade-A  
Weight (kg)..... 495

## Environment condition

Ambient temp. min. (°C)..... -20  
Ambient temp. max. (°C)..... 45  
Altitude (mtr up to)..... 1000

## Bearing

DE Bearing..... 6317/C3  
NDE Bearing..... 6314/C3  
Fixed bearing..... DE

## Terminal box

Tbox position..... Top  
Cable entry direction..... Right (from DE)  
Cable entry  
Main..... 2 x M63x1,5  
Ø37-44mm metal  
Accessory..... 2 x M20x1,5  
Metal blindcaps  
Terminal board thread..... 6-M10

## Motor protection

Thermal protection main..... PTC 3x 155 dgr  
Thermal protection second..: None  
Space heater..... 1x 230V 100W  
Temperature detector..... No  
SPM..... No  
IR wire..... No  
Tropical insulation..... Yes

## Explosion protection

According to..... None  
Type of protection..... None

## General

Direction of rotation..... CW  
Painting..... RAL 9005  
Nameplate..... Multivoltage + VFD  
Special packing..... No  
Special requirements..... No

## Test values

Rotor inertia (kgm²)..... 1,52  
Noise level (dB(A))..... 69  
No load current (A)..... 30,0  
Winding resist. (ohm)..... 0,18  
Starting time (sec.)..... 0,17  
Temp. rise winding (K)..... 79  
Temp. rise surface (K)..... 71

|                           |                  |                  |                  |                  |
|---------------------------|------------------|------------------|------------------|------------------|
| Rated power (kW)          | 45,0             | 43,5             | 54,0             | 52,5             |
| Frequency (Hz)            | 50               | 50               | 60               | 60               |
| Voltage (V)               | 400 690          | 380 660          | 480 830          | 440              |
| Connection                | D Y              | D Y              | D Y              | D                |
| Full load current (A)     | 81,0 47,0        | 83,0 48,5        | 81,0 47,0        | 85,0             |
| Speed (rpm)               | 990              | 990              | 1180             | 1180             |
| Power factor cos(phi)     | 0,87             | 0,87             | 0,87             | 0,88             |
| Efficiency, 100/75/50 (%) | 92,7/ 92,4 /91,4 | 92,7/ 92,4 /91,4 | 92,7/ 92,4 /91,4 | 92,2/ 91,8 /90,8 |
| Ist/In                    | 6,95             | 6,15             | 6,95             | 6,40             |
| Full load torque (Nm)     | 440              | 425              | 440              | 425              |
| Tst/Tn                    | 2,38             | 2,20             | 2,38             | 2,06             |
| Tmax/Tn                   | 2,80             | 2,60             | 2,80             | 2,40             |
| Duty                      | S1               | S1               | S1               | S1               |
| Ambient temp. (°C)        | 40               | 45               | 40               | 45               |