

Data Sheet

Itemnumber.....: 6020800200

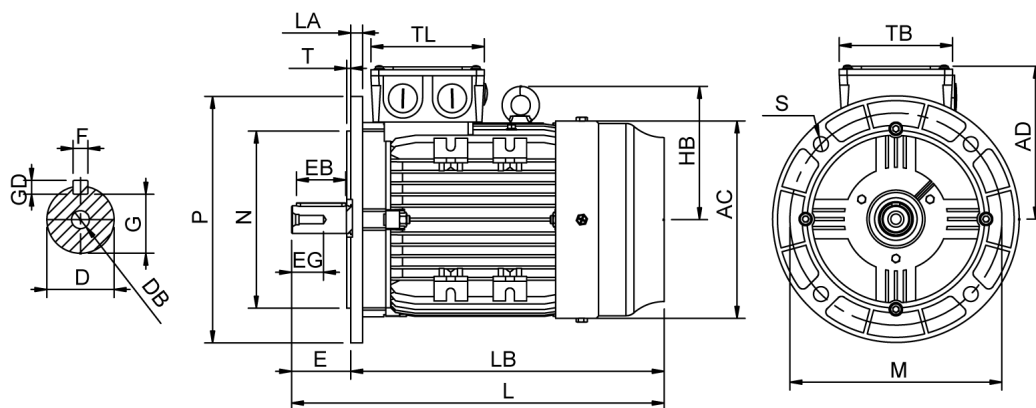

AC = 157	DB = M6	EG = 16	GD = 6	LB = 256	P = 200	TB = 110
AD = 123	E = 40	F = 6	L = 296	M = 165	S = 4-Ø12	TL = 110
D = 19	EB = 32	G = 15,50	LA = 9	N = 130	T = 3,50	

Version

Type.....: HMA4 80M1-2
Design.....: Induction motor
Standard series.....: IEC 60034
Phase / Voltage range.....: 3~ / Low

Electrical design

Efficiency.....: IE4
Pole.....: 2
Power at 50 Hz (kW).....: 0,75
Hz.....: 50
Voltage.....: 230VD/400VY
Winding voltage.....: 230VD/400VY 50 Hz
Power output (kW).....: 0,75
Duty.....: S1
Insulation class.....: F
Temperature rise.....: B

Mechanical design

Frame size.....: 80
Mounting.....: B5
Rain cap.....: No
Protection class.....: IP55
Cooling method.....: IC411/TEFC
External grounding.....: Yes
Drain hole.....: Yes
Frame material.....: Aluminium
Material approval.....: None
Shaft.....: IEC standard
Key.....: Closed key
Balancing.....: Half key balancing
Vibration class.....: Grade-A
Weight (kg).....: 12,0

Environment condition

Ambient temp. min. (°C).....: -20
Ambient temp. max. (°C).....: 40
Altitude (mtr up to).....: 1000

Bearing

DE Bearing.....: 6204-ZZ/C3
NDE Bearing.....: 6203-ZZ/C3
Fixed bearing.....: DE

Terminal box

Tbox position.....: Top
Cable entry direction.....: Right (from DE)
Cable entry
Main.....: 2 x M20x1,5
Plastic blindcaps
Accessory.....: 1 x M12x1,5
Plastic blindcap
Terminal board thread.....: M4

Test values

Rotor inertia (kgm²).....: 0,0010
Noise level (dB(A)).....: 55
Starting time (sec.).....: 0,03

Motor protection

Thermal protection main.....: PTC 3x 155 dgr
Thermal protection second.....: None
Space heater.....: None None
Temperature detector.....: No
SPM.....: No
IR wire.....: No
Tropical insulation.....: No

Explosion protection

According to.....: None
Type of protection.....: None

General

Direction of rotation.....: CW
Painting.....: RAL 9005
Nameplate.....: Multivoltage
Special packing.....: No
Special requirements.....: No

Rated power (kW)	0,75	0,73	0,90	0,87
Frequency (Hz)	50	50	60	60
Voltage (V)	230 400	220 380	280 480	440
Connection	D Y	D Y	D Y	Y
Full load current (A)	2,90 1,66	3,00 1,72	2,90 1,66	1,72
Speed (rpm)	2870	2870	3440	3440
Power factor cos(phi)	0,78	0,79	0,78	0,80
Efficiency, 100/75/50 (%)	83,5/84,6/83,1	83,5/84,6/83,1	83,5/84,6/83,1	82,3/83,5/81,9
Ist/In	7,30	6,40	7,30	6,70
Full load torque (Nm)	2,50	2,42	2,50	2,42
Tst/Tn	4,60	4,30	4,60	4,00
Tmax/Tn	3,90	3,65	3,90	3,40
Duty	S1	S1	S1	S1
Ambient temp. (°C)	40	45	40	45