

# Data Sheet

Itemnumber.....: 6021000200

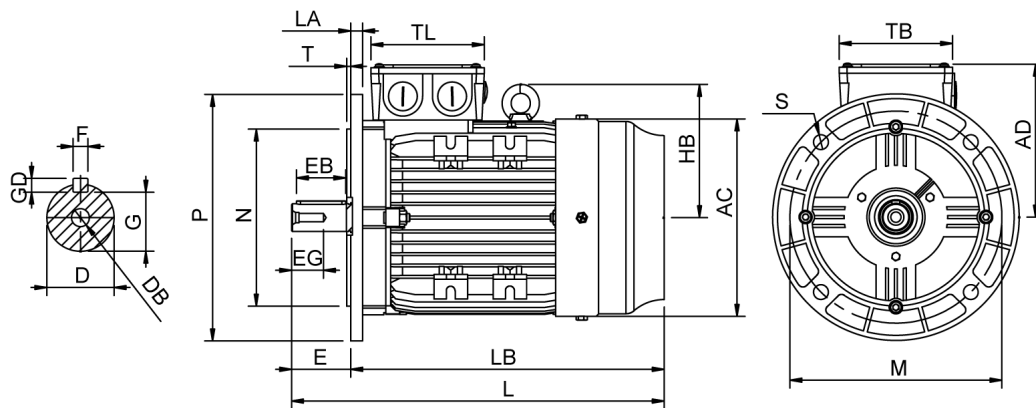

AC = 199	DB = M10	EG = 28	GD = 7	LB = 358	P = 250	TB = 115
AD = 159	E = 60	F = 8	L = 418	M = 215	S = 4-Ø14.5	TL = 115
D = 28	EB = 50	G = 24	LA = 12	N = 180	T = 4	

## Version

Type.....: HMA4 100L-2  
Design.....: Induction motor  
Standard series.....: IEC 60034  
Phase / Voltage range.....: 3~ / Low

## Electrical design

Efficiency.....: IE4  
Pole.....: 2  
Power at 50 Hz (kW).....: 3,00  
Hz.....: 50  
Voltage.....: 230VD/400VY  
Winding voltage.....: 230VD/400VY 50 Hz  
Power output (kW).....: 3,00  
Duty.....: S1  
Insulation class.....: F  
Temperature rise.....: B

## Mechanical design

Frame size.....: 100  
Mounting.....: B5  
Rain cap.....: No  
Protection class.....: IP55  
Cooling method.....: IC411/TEFC  
External grounding.....: Yes  
Drain hole.....: Yes  
Frame material.....: Aluminium  
Material approval.....: None  
Shaft.....: IEC standard  
Key.....: Closed key  
Balancing.....: Half key balancing  
Vibration class.....: Grade-A  
Weight (kg).....: 27,0

## Environment condition

Ambient temp. min. (°C).....: -20  
Ambient temp. max. (°C).....: 40  
Altitude (mtr up to).....: 1000

## Bearing

DE Bearing.....: 6306-ZZ/C3  
NDE Bearing.....: 6205-ZZ/C3  
Fixed bearing.....: DE

## Terminal box

Tbox position.....: Top  
Cable entry direction.....: Right (from DE)  
Cable entry  
Main.....: 2 x M25x1,5  
Plastic blindcaps  
Accessory.....: 1 x M20x1,5  
Plastic blindcap  
Terminal board thread.....: M5

## Test values

Rotor inertia (kgm²).....: 0,0050  
Noise level (dB(A)).....: 63  
Starting time (sec.).....: 0,04

## Motor protection

Thermal protection main.....: PTC 3x 155 dgr  
Thermal protection second.....: None  
Space heater.....: None None  
Temperature detector.....: No  
SPM.....: No  
IR wire.....: No  
Tropical insulation.....: No

## Explosion protection

According to.....: None  
Type of protection.....: None

## General

Direction of rotation.....: CW  
Painting.....: RAL 9005  
Nameplate.....: Multivoltage  
Special packing.....: No  
Special requirements.....: No

Rated power (kW)	3,00	2,90	3,60	3,50
Frequency (Hz)	50	50	60	60
Voltage (V)	230 400	220 380	280 480	440
Connection	D Y	D Y	D Y	Y
Full load current (A)	9,70 5,60	10,00 5,75	9,70 5,60	5,75
Speed (rpm)	2910	2910	3490	3490
Power factor cos(phi)	0,87	0,88	0,87	0,88
Efficiency, 100/75/50 (%)	89,1/88,9/87,5	89,1/88,9/87,5	89,1/88,9/87,5	88,3/88,1/86,6
Ist/In	11,4	10,00	11,4	10,4
Full load torque (Nm)	9,85	9,55	9,85	9,55
Tst/Tn	5,10	4,75	5,10	4,40
Tmax/Tn	4,60	4,30	4,60	4,00
Duty	S1	S1	S1	S1
Ambient temp. (°C)	40	45	40	45