

Data Sheet

Itemnumber.....: 6041001200

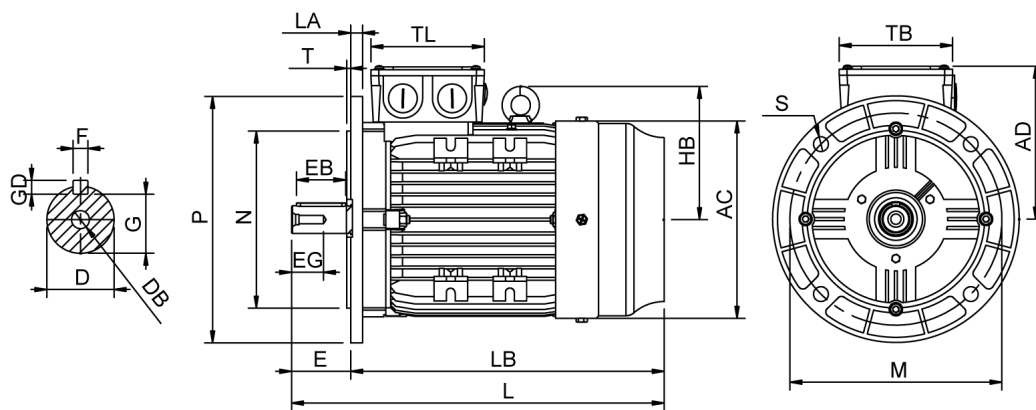

AC = 199	DB = M10	EG = 28	GD = 7	LB = 358	P = 250	TB = 115
AD = 159	E = 60	F = 8	L = 418	M = 215	S = 4-Ø14.5	TL = 115
D = 28	EB = 50	G = 24	LA = 12	N = 180	T = 4	

Version

Type.....: HMA4 100L2-4
Design.....: Induction motor
Standard series.....: IEC 60034
Phase / Voltage range.....: 3~ / Low

Electrical design

Efficiency.....: IE4
Pole.....: 4
Power at 50 Hz (kW).....: 3,00
Hz.....: 50
Voltage.....: 230VD/400VY
Winding voltage.....: 230VD/400VY 50 Hz
Power output (kW).....: 3,00
Duty.....: S1
Insulation class.....: F
Temperature rise.....: B

Motor protection

Thermal protection main....: PTC 3x 155 dgr
Thermal protection second..: None
Space heater.....: None None
Temperature detector.....: No
SPM.....: No
IR wire.....: No
Tropical insulation.....: No

Explosion protection

According to.....: None
Type of protection.....: None

General

Direction of rotation.....: CW
Painting.....: RAL 9005
Nameplate.....: Multivoltage
Special packing.....: No
Special requirements.....: No

Mechanical design

Frame size.....: 100
Mounting.....: B5
Rain cap.....: No
Protection class.....: IP55
Cooling method.....: IC411/TEFC
External grounding.....: Yes
Drain hole.....: Yes
Frame material.....: Aluminium
Material approval.....: None
Shaft.....: IEC standard
Key.....: Closed key
Balancing.....: Half key balancing
Vibration class.....: Grade-A
Weight (kg).....: 34,0

Environment condition

Ambient temp. min. (°C)..: -20
Ambient temp. max. (°C)..: 40
Altitude (mtr up to).....: 1000

Bearing

DE Bearing.....: 6306-ZZ/C3
NDE Bearing.....: 6205-ZZ/C3
Fixed bearing.....: DE

Terminal box

Tbox position.....: Top
Cable entry direction.....: Right (from DE)
Cable entry
Main.....: 2 x M25x1,5
Plastic blindcaps
Accessory.....: 1 x M20x1,5
Plastic blindcap
Terminal board thread.....: M5

Test values

Rotor inertia (kgm²).....: 0,010
Noise level (dB(A)).....: 55
Starting time (sec.).....: 0,02

Rated power (kW)	3,00	2,90	3,60	3,50
Frequency (Hz)	50	50	60	60
Voltage (V)	230 400	220 380	280 480	440
Connection	D Y	D Y	D Y	Y
Full load current (A)	10,8 6,20	11,2 6,40	10,8 6,20	6,40
Speed (rpm)	1460	1460	1750	1750
Power factor cos(phi)	0,77	0,78	0,77	0,79
Efficiency, 100/75/50 (%)	90,4/89,6/88,3	90,4/89,6/88,3	90,4/89,6/88,3	89,7/88,9/87,5
Ist/In	10,6	9,25	10,6	9,65
Full load torque (Nm)	19,6	19,2	19,6	19,2
Tst/Tn	4,10	3,80	4,10	3,55
Tmax/Tn	4,40	4,10	4,40	3,80
Duty	S1	S1	S1	S1
Ambient temp. (°C)	40	45	40	45