

# Data Sheet

Itemnumber.....: 6061321200

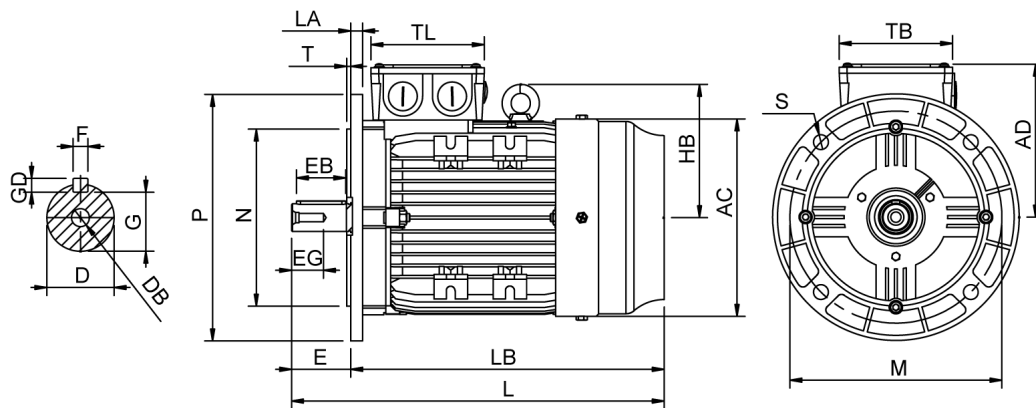

AC = 260	DB = M12	EG = 30	GD = 8	LA = 14	N = 230	T = 4
AD = 192	E = 80	F = 10	HB = 180	LB = 433	P = 300	TB = 138
D = 38	EB = 70	G = 33	L = 513	M = 265	S = 4-Ø14.5	TL = 138

## Version

Type.....: HMA4 132M1-6  
Design.....: Induction motor  
Standard series.....: IEC 60034  
Phase / Voltage range.....: 3~ / Low

## Electrical design

Efficiency.....: IE4  
Pole.....: 6  
Power at 50 Hz (kW).....: 4,00  
Hz.....: 50  
Voltage.....: 400VD/690VY  
Winding voltage.....: 400VD/690VY 50 Hz  
Power output (kW).....: 4,00  
Duty.....: S1  
Insulation class.....: F  
Temperature rise.....: B

## Mechanical design

Frame size.....: 132  
Mounting.....: B5  
Rain cap.....: No  
Protection class.....: IP55  
Cooling method.....: IC411/TEFC  
External grounding.....: Yes  
Drain hole.....: Yes  
Frame material.....: Aluminium  
Material approval.....: None  
Shaft.....: IEC standard  
Key.....: Closed key  
Balancing.....: Half key balancing  
Vibration class.....: Grade-A  
Weight (kg).....: 63,0

## Environment condition

Ambient temp. min. (°C).....: -20  
Ambient temp. max. (°C).....: 40  
Altitude (mtr up to).....: 1000

## Bearing

DE Bearing.....: 6208-ZZ/C3  
NDE Bearing.....: 6206-ZZ/C3  
Fixed bearing.....: DE

## Terminal box

Tbox position.....: Top  
Cable entry direction.....: Right (from DE)  
Cable entry  
Main.....: 2 x M32x1,5  
Plastic blindcaps  
Accessory.....: 1 x M20x1,5  
Plastic blindcap  
Terminal board thread.....: M5

## Test values

Rotor inertia (kgm²).....: 0,060  
Noise level (dB(A)).....: 53  
Starting time (sec.).....: 0,06

## Motor protection

Thermal protection main.....: PTC 3x 155 dgr  
Thermal protection second..: None  
Space heater.....: None None  
Temperature detector.....: No  
SPM.....: No  
IR wire.....: No  
Tropical insulation.....: No

## Explosion protection

According to.....: None  
Type of protection.....: None

## General

Direction of rotation.....: CW  
Painting.....: RAL 9005  
Nameplate.....: Multivoltage  
Special packing.....: No  
Special requirements.....: No

Rated power (kW)	4,00	3,90	4,80	4,65
Frequency (Hz)	50	50	60	60
Voltage (V)	400 690	380 660	480 830	440
Connection	D Y	D Y	D Y	D
Full load current (A)	8,60 5,00	8,85 5,15	8,60 5,00	8,85
Speed (rpm)	980	980	1170	1170
Power factor cos(phi)	0,75	0,76	0,75	0,78
Efficiency, 100/75/50 (%)	89,5/89,3/88,0	89,5/89,3/88,0	89,5/89,3/88,0	88,8/88,6/87,2
Ist/In	7,50	6,60	7,50	6,90
Full load torque (Nm)	39,0	38,0	39,0	38,0
Tst/Tn	2,80	2,60	2,80	2,42
Tmax/Tn	3,10	2,90	3,10	2,70
Duty	S1	S1	S1	S1
Ambient temp. (°C)	40	45	40	45